



## Board & Batten

Installed vertically as siding, Delta Metals Board & Batten recreates the rustic look and feel of traditional board & batten in steel, the toughest most durable and long lasting siding material possible. Our new profile is available in 29 gauge metal as a siding option for you business or home.

**26**  
Gauge

**3/4"**  
MAXIMUM  
RIB HEIGHT

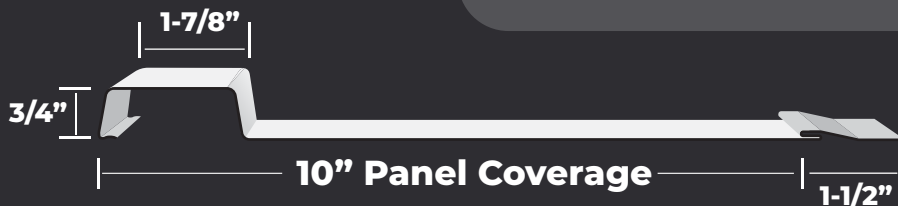
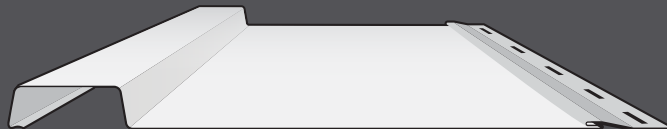

Concealed fastening surface for that hidden fastener look.

Unique lap groove that hides the overlap providing a smooth, clean appearance.

### Important Disclaimers:

- **NOT** recommended for over 10' panels  
Use freeze boards where possible
- Do **NOT** use a fastener with a rubber washer  
Use a pan screw
- Needs to freely hang, like vinyl siding  
In order to reduce oil canning





## MINIMUM SPECIFICATION

Available Gauges: **26 Gauge**

Steel Thickness: **0.0153"**

Paint System: **SHERWIN-WILLIAMS**  
Coil Coatings **SMP** WeatherXL™

Warranty:

40 Year Lifetime Limited Paint Adhesion

30 Year Chalk and Fade

Rust Protection Substrate:

Galvalume AZ50

Delta Metals is neither partially or solely responsible for improper installation or defects as a result of installation

## Product Highlights

- Available in 25 Smooth colors & 15 Textured colors (Textured options *MAY* vary from coil to coil)
- 10" Panel Coverage
- 8" Rib Spacing
- 3/4" Rib Height
- Fits all or standard 3/4" Rib Trims
- Snaps into place for easy of install

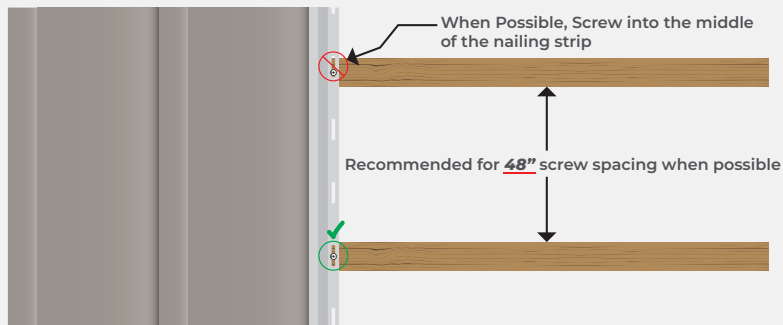
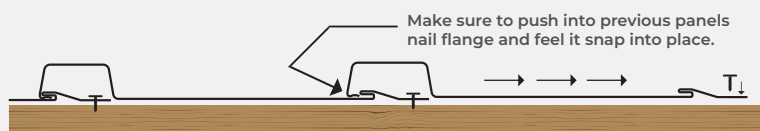

Visit Us At:

**DELTAMETALS.COM**



**SHERWIN-WILLIAMS**  
Coil Coatings

